



**\$625,000**

## **18180 N US HWY 441, REDDICK, FL 32686, USA**

<https://restaurantsalesleasing.com>

5 acres with 330 feet of frontage on N US 441 in Reddick. This property is zoned A3 currently and is able to be rezoned to commercial property B2. This is a great opportunity to own 5 acres that short drive to Gainesville or Ocala. There is a 784 sqft 2/2 mobile home and 31 [...]

- 2 beds
- 1 bath
- Manufactured Home - Post 1977
- Residential
- Active
- 784 sq ft

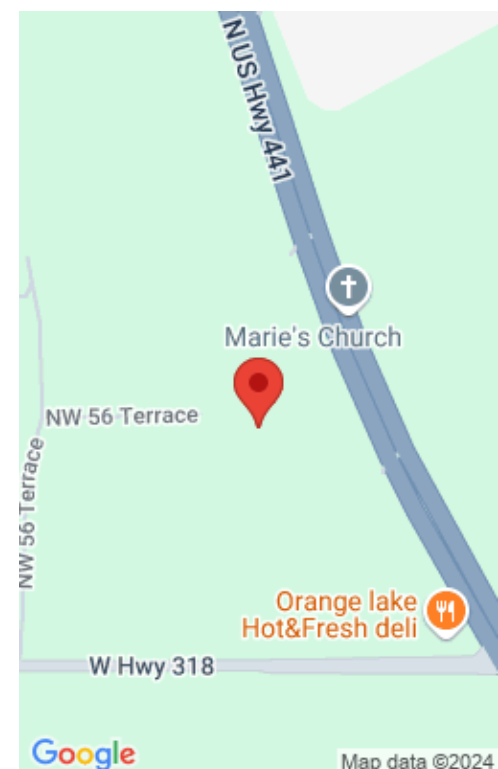

---

## Basics

**Category:** Residential

**Status:** Active

**Bathrooms:** 1 bath

**Area:** 784 sq ft

**Subdivision Name:** NON HOME SUB

**Parcel Number:** 03100-000-00

**Bathrooms Full:** 1

**DOM:** 1

**List Office MLS ID:** MFR271500038

**Type:** Manufactured Home - Post 1977

**Bedrooms:** 2 beds

**Half baths:** 0 half baths

**Year built:** 1984

**Total Acreage:** 5 to less than 10 acres

**Township:** 12S

**County:** Marion

**Lot Size Acres:** 5 acres

---

## Building Details

**Stories Total:** 1

**Roof:** Metal

**Water Source:** Well

**Flooring:** Carpet, Linoleum

**Number Of Wells:** 1

**Other Structures:** Shed(s), Storage

**Construction Materials:** Metal Siding

**Heating:** Central

---

## Amenities & Features

**Security Features:** Security System

**Utilities:** Cable Available, Electricity Connected, Water Connected

**Exterior Features:** Other

**Laundry Features:** Inside

**Sewer:** Septic Tank

**Appliances:** Electric Water Heater, Range, Refrigerator

**Interior Features:** Ceiling Fans(s), Kitchen/Family Room Combo, Window Treatments

---

## Fees & Taxes



**Tax Annual Amount:** \$2,142

**Tax Year:** 2023

---

## Miscellaneous

**Possession:** Close of Escrow

**Ownership:** Fee Simple

**Zoning:** A3

**List Office Name:** COLDWELL BANKER ELLISON REALTY O

**Attribution Contact:** 352-732-8350

